

# Through Hole Power Inductors

## THXR1290 Type

### Features

- RoHS compliant.
- High current through hole type.
- Magnetically shielded, suitable for high density mounting.
- High energy storage and low DCR.
- Ideal for power source circuits, DC-DC converter, DC-AC inverters inductor application.
- In addition to the standard versions shown here, customized inductors are available to meet your exact requirements.

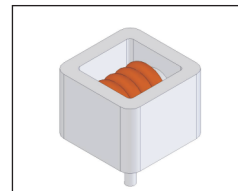

### Mechanical Dimension:

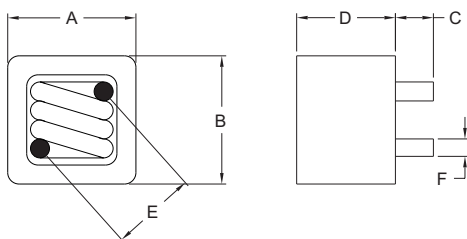

### RECOMMENDED PAD PATTERNS

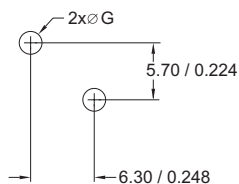

UNIT : mm/inch  
 A = 11.90 / 0.469 Max.  
 B = 11.90 / 0.469 Max.  
 C = 3.50 ± 0.5 / 0.138 ± 0.020  
 D = 9.00 / 0.354 Max.  
 E = 9.48 ± 0.5 / 0.373 ± 0.020

### Electrical Characteristics : At 25°C: 100KHz, 1V

PART NO.	$L^1$ ( $\mu$ H)	$I_{sat}^2$ (A $\sqrt{dc}$ )	$I_{rms}^3$ (A $\sqrt{dc}$ )	DCR ( $m\Omega$ ) $\pm 8\%$	F $\pm 0.1$ (mm/inch)	F $\pm 0.1$ (mm/inch)
THXR1290-R47	0.47	45.00	24.00	0.76	1.5 / 0.059	1.8 / 0.071
THXR1290-0R6	0.60	26.00	20.00	0.76	1.5 / 0.059	1.8 / 0.071
THXR1290-0R8	0.80	24.00	12.00	1.20	1.3 / 0.051	1.6 / 0.063
THXR1290-1R0	1.00	18.00	11.00	1.20	1.3 / 0.051	1.6 / 0.063
THXR1290-1R5	1.50	13.00	11.00	1.70	1.2 / 0.047	1.5 / 0.059
THXR1290-2R0	2.00	10.00	9.00	2.70	1.00 / 0.039	1.30 / 0.051
THXR1290-3R3	3.30	8.00	8.00	5.30	0.80 / 0.032	1.10 / 0.043

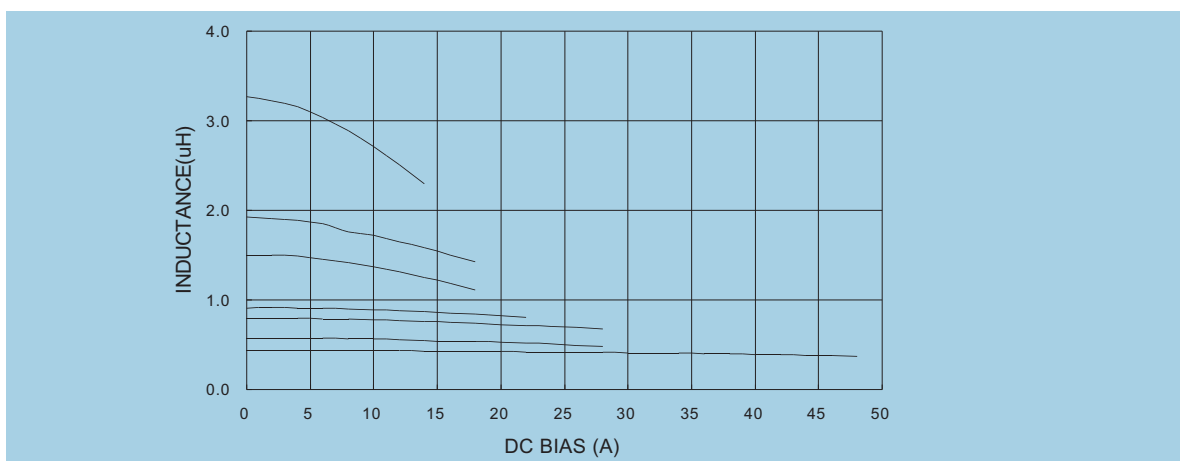

1.  $L_0$  is the initial inductance and the tolerance is  $\pm 20\%$ .
2.  $I_{sat}$  is the DC current which cause the inductance drop approximately 20% of its nominal inductance without current.
3.  $I_{rms}$  is the DC current which cause the surface temperature of the part increase approximately 45°C.
4. Operating temperature : -20°C to 105°C ( including self-temperature rise ).



**DELTA ELECTRONICS, INC.**

(TAOYUAN PLANT CPBG) 252, SAN YING ROAD, KUEISAN INDUSTRIAL ZONE, TAOYUAN SHIEN, 333, TAIWAN, R.O.C.

TEL: 886-3-3591968; FAX: 886-3-3591991

<http://www.deltawww.com>

## Free Manuals Download Website

<http://myh66.com>

<http://usermanuals.us>

<http://www.somanuals.com>

<http://www.4manuals.cc>

<http://www.manual-lib.com>

<http://www.404manual.com>

<http://www.luxmanual.com>

<http://aubethermostatmanual.com>

Golf course search by state

<http://golfingnear.com>

Email search by domain

<http://emailbydomain.com>

Auto manuals search

<http://auto.somanuals.com>

TV manuals search

<http://tv.somanuals.com>