

# SMT Power Inductor

## SILM630 Type

### Features

- RoHS compliant.
- Low profile (3.0mm max. height) SMD type.
- Magnetically shielded, suitable for high density mounting.
- Self-leads, suitable for high density mounting.
- High energy storage and low DCR.
- Provided with embossed carrier tape packing.
- Ideal for power source circuits, DC-DC converter, DC-AC inverters inductor applications.
- In addition to the standard versions shown here, customized inductors are available to meet your exact requirements.

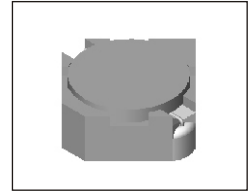

### Mechanical Dimension:

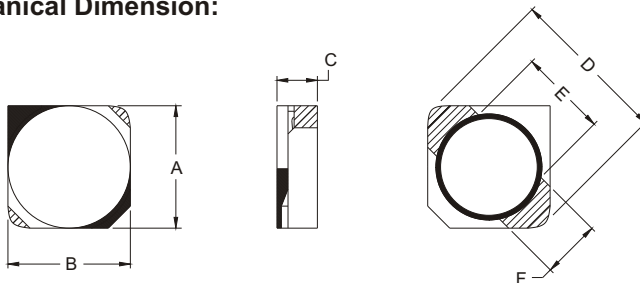

### RECOMMENDED PAD PATTERNS

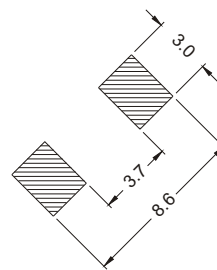

UNIT:mm/inch  
 A = 6.0 / 0.236 Max.  
 B = 6.0 / 0.236 Max.  
 C = 3.0 / 0.118 Max.  
 D = 7.8 / 0.307 Max.  
 E = 4.4±0.3 / 0.173±0.012  
 F = 2.0±0.2 / 0.079±0.008

### Electrical Characteristics: 25°C: 100KHz, 0.1V

PART NO.	L <sup>1</sup> (μH)	DCR (mΩ) MAX	I <sub>rated</sub> <sup>2</sup> (Adc)
SILM630 -2R6	2.6	18	2.60
SILM630 -3R0	3.0	24	2.40
SILM630 -4R2	4.2	31	2.20
SILM630 -5R3	5.3	38	1.90
SILM630 -6R2	6.2	45	1.80
SILM630 -8R2	8.2	53	1.60
SILM630 -100	10.0	65	1.30
SILM630 -120	12.0	76	1.20
SILM630 -150	15.0	103	1.10
SILM630 -180	18.0	110	1.00
SILM630 -220	22.0	122	0.90
SILM630 -270	27.0	175	0.85
SILM630 -330	33.0	189	0.75
SILM630 -390	39.0	212	0.70
SILM630 -470	47.0	260	0.62
SILM630 -560	56.0	305	0.58
SILM630 -680	68.0	355	0.52
SILM630 -820	82.0	463	0.46
SILM630 -101	100.0	520	0.42

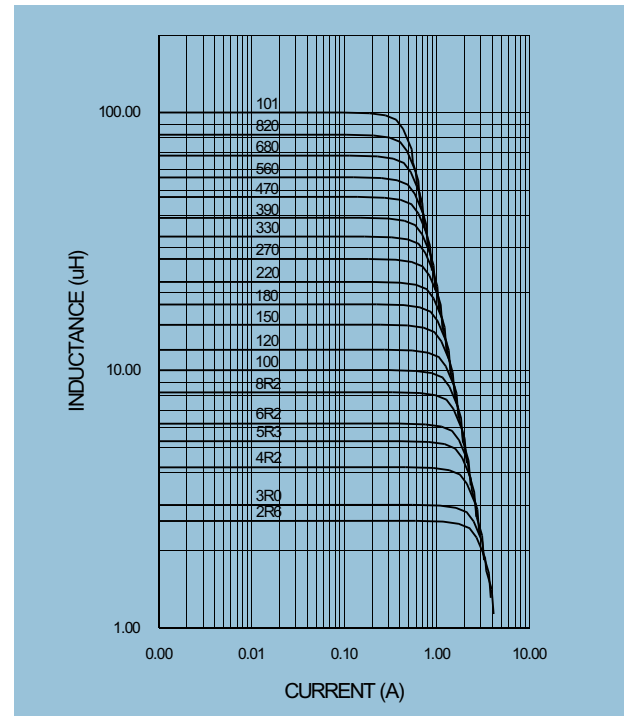

1. Tolerance of inductance: ±30%.
2. I<sub>rated</sub> is the DC current which cause the inductance drop less than 35% of its nominal inductance without current and the surface temperature of the part increase less than 45°C.
3. Operating temperature : -20°C to 105°C (including self-temperature rise).



**DELTA ELECTRONICS, INC.**

(TAOYUAN PLANT CPBG) 252, SAN YING ROAD, KUEISAN INDUSTRIAL ZONE, TAOYUAN SHIEN, 333, TAIWAN, R.O.C.

TEL: 886-3-3591968; FAX: 886-3-3591991

<http://www.deltawww.com>

## Free Manuals Download Website

<http://myh66.com>

<http://usermanuals.us>

<http://www.somanuals.com>

<http://www.4manuals.cc>

<http://www.manual-lib.com>

<http://www.404manual.com>

<http://www.luxmanual.com>

<http://aubethermostatmanual.com>

Golf course search by state

<http://golfingnear.com>

Email search by domain

<http://emailbydomain.com>

Auto manuals search

<http://auto.somanuals.com>

TV manuals search

<http://tv.somanuals.com>