





PORTABLE CD PLAYER with CASSETTE RECORDER and AM/FM STEREO RADIO

INSTRUCTION MANUAL RCD 310

WARNING

-TO PREVENT FIRE OR SHOCK HAZARD, DO NOT USE THIS PLUG WITH AN EXTENSION CORD, RECEPTACLE OR OTHER OUTLET UNLESS THE BLADES CAN BE FULLY INSERTED TO PREVENT BLADE EXPOSURE.

-TO PREVENT FIRE OR SHOCK HAZARD, DO NOT EXPOSE THIS APPLIANCE TO RAIN OR MOISTURE.

	CAUTION RISK OF ELECTRIC SHOCK DO NOT OPEN	
The lightning flash with arrowhead symbol, within an equilateral triangle, is intended to alert the user to the presence of uninsulated 'dangerous voltage' within the product's enclosure that may be of sufficient magnitude to constitute a risk of electric shock to persons.	CAUTION: TO REDUCE THE RISK OF ELECTRIC SHOCK, DO NOT REMOVE COVER (OR BACK) NO USER-SERVICEABLE PARTS INSIDE. REFER SERVICING TO QUALIFIED SERVICE PERSONNEL.	The exclamation point within an equilateral triangle is intended to alert the user to the presence of important operating and maintenance (servicing) instructions in the literature accompanying the appliance.

IMPORTANT SAFETY INSTRUCTIONS

- 1) Read these instructions.
- 2) Keep these instructions.
- 3) Heed all warnings.
- 4) Follow all instructions.
- 5) Do not use this apparatus near water.
- 6) Clean only with dry cloth.
- 7) Do not block any ventilation openings. Install in accordance with the manufacturer's instructions.
- 8) Do not install near any heat sources such as radiators, heat registers, stoves, or other apparatus (including amplifiers) that produce heat.
- 9) Do not defeat the safety purpose of the polarized or grounding-type plug. A polarized plug has two blades with one wider than the other. A grounding type plug has two blades and a third grounding prong. The wide blade or the third prong are provided for your safety. If the provided plug does not fit into your outlet, consult an electrician for replacement of the obsolete outlet.
- 10) Protect the power cord from being walked on or pinch particularly at plugs, convenience receptacles, and the point where they exit from the apparatus.
- 11) Only use attachments/accessories specified by the manufacturer.
- 12) Unplug this apparatus during lightening storms or when unused for long periods of time.
- 13) Refer all servicing to qualified service personnel. Servicing is required when the apparatus has been damaged in any way, such as power-supply cord or plug is damaged, liquid has been spilled or objects have fallen into the apparatus, the apparatus, has been exposed to rain or moisture, does not operate normally, or has been dropped.

This appliance shall not be exposed to dripping or splashing water and that no object filled with liquid such as vases shall be placed on the apparatus.

810-00000S-190

PREPARATION FOR USE

Unpacking and Setup

- Carefully remove the unit from the display carton and remove all packing material from the unit itself.
- Remove any descriptive labels that may be found on either the front or top cabinet of the unit. Do not remove any labels located on either the back or bottom cabinet of the unit.
- The detachable AC power cord is packed in the carton separately from the unit. Make sure that the AC power cord is not accidentally discarded with the carton or packing material.
- CD open compartment door. There is a white card in the CD compartment which is intended to prevent the CD pickup from moving during shipment of the product. Remove this card from the CD compartment before use.

Power Sources

This portable audio system is designed to operate on either AC 120V 60Hz house current or 12V DC, using 8 "D" batteries (UM-1), not included. Attempting to operate this unit from any other power source may cause damage to unit, which is not covered by your warranty.

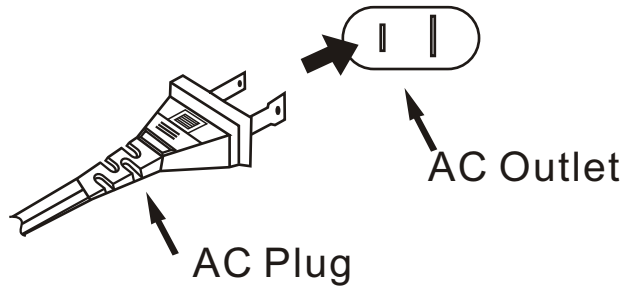

AC Operation

Unwind the AC cord and extend it to its full length, Insert the small end of the AC cord into the AC socket on the back cabinet of the unit. Insert the other end of the AC cord into any convenient AC 120V 60Hz household outlet.

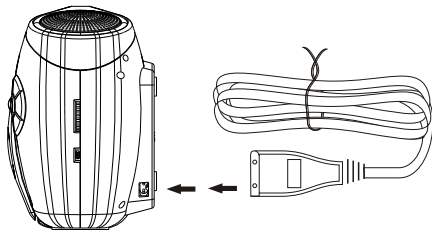

Battery Operation

The battery compartment is located on the bottom of the cabinet.

- Remove the battery compartment door by pressing downward on the two tabs as shown in Figure 1 below.
- Insert 8 "D" size (UM-1) batteries into the battery compartment as shown in figure 2 below. Be sure to observe the polarity markings which are engraved inside the battery compartment. If the batteries are inserted incorrectly, the unit will not operate.

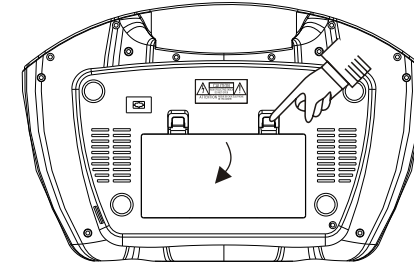

Figure 1

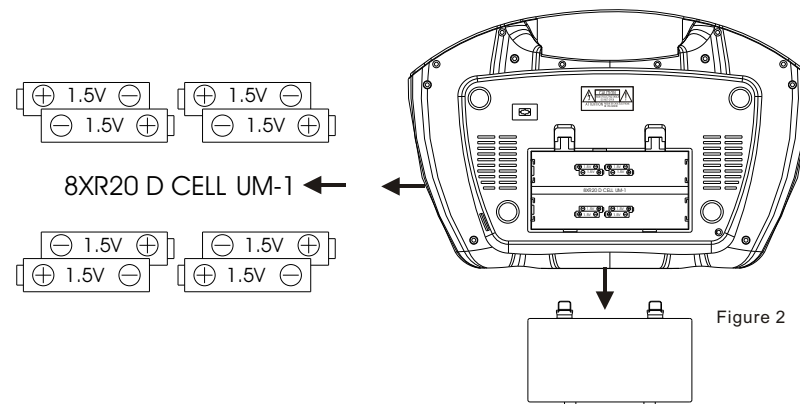

Figure 2

- Replace the battery compartment door.

NOTE: The AC power cord must be disconnected from the AC socket on the back of the unit in order for the unit to operate on battery power.

BATTERY PRECAUTIONS

Follow these precautions when using batteries in this device.

1. Use only the size and type of batteries specified.
2. Be sure to follow the correct polarity when installing the batteries as indicated in the battery compartment. Reversed batteries may cause damage to the device.
3. Do not mix different types of batteries together (e.g. Alkaline and Carbon-zinc) or old batteries with fresh ones.
4. If the device is not to be used for a long period of time, remove the batteries to prevent damage or injury from possible battery leakage.
5. Do not try to recharge batteries not intended to be recharged; they can overheat and rupture. (Follow battery manufacturers' directions.)

LOCATION OF CONTROLS AND INDICATORS

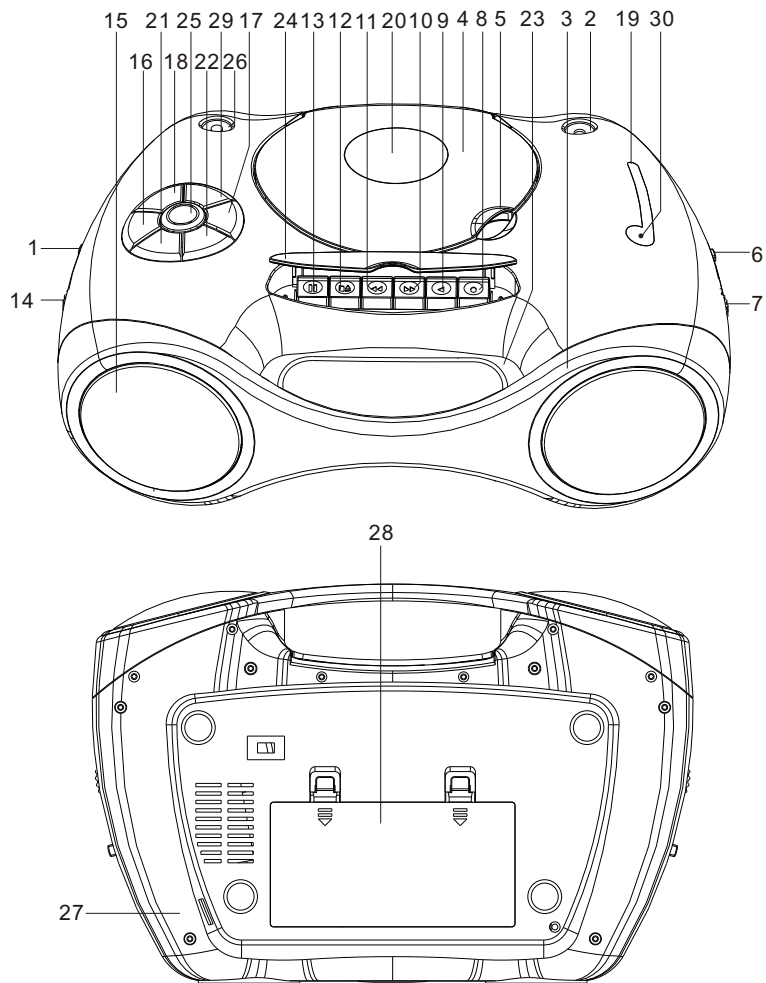

1. FUNCTION SWITCH
2. FM ANTENNA
3. HANDLE
4. CD DOOR
5. CD DOOR OPEN
6. BAND SWITCH
7. TUNING KNOB
8. CASSETTE RECORD BUTTON
9. CASSETTE PLAY BUTTON
10. CASSETTE REWIND BUTTON
11. CASSETTE F.WD BUTTON
12. CASSETTE STOP/EJECT BUTTON
13. CASSETTE PAUSE BUTTON
14. VOLUME KNOB
15. SPEAKERS

16. CD SKIP/SEARCH (◀◀) BUTTON
17. CD SKIP/SEARCH (▶▶) BUTTON
18. CD REPEAT ONE/ALL BUTTON
19. RADIO DIAL WINDOW
20. CD TRACK(S) INDICATOR
21. CD STOP BUTTON
22. CD PLAY/PAUSE BUTTON
23. CASSETTE DOOR
24. CASSETTE KNOB COVER
25. DBBS BUTTON
26. PHONES SOCKET
27. AC INPUT SOCKET
28. BATTERY COMPARTMENT
29. PROGRAM BUTTON
30. FM STEREO INDICATOR

NOTE: The manufacturer is not responsible for any RADIO interference cause by unauthorized modifications to this equipment. Such modifications could void the user's authority to operate the equipment.

**WARNING : TO PREVENT FIRE OR SHOCK HAZARD.
DO NOT EXPOSE THIS UNIT TO RAIN OR MOISTURE.**

AVOID INSTALLING THE UNIT IN LOCATIONS DESCRIBED BELOW:

- * Areas exposed to direct sunlight or close to heat radiating appliances such as electric heaters.
- On top of other stereo equipment that radiates too much heat.
- Places lacking ventilation or dusty place.
- Areas subject to constant vibration.
- Humid or moist locations
- Operate controls and switches as described in the manual.
- Before tuning the power switch on for the first time, make certain the batteries and power cords are properly installed.
- * Store your tapes and CDs in cool area to avoid damage from the heat.

AC POWER CONNECTION

Connect one end of the AC cord to the AC INPUT socket (27) on the back of the unit, then connect other end to the wall outlet. The unit is now ready to operate by AC power supply.

Disconnect AC cord from wall outlet when the unit is not in use.

BATTERY INSTALLATION

1. Open the battery compartment cover.
2. Insert 8 pcs. "D" R20 UM-1x8 or type batteries into battery compartment. Be sure to insert battery's polarity as shown in the diagram engraved on the battery compartment.
3. Place the battery compartment cover.
4. The unit is now ready for operation.

NOTE: The battery circuit is disconnected automatically when the AC cord is inserted to the AC INPUT socket when operate by AC. Remove all the batteries from battery compartment, when the unit is longer operate by battery.

**DO NOT EXPOSE THE RADIO TO DRIPPING OR SPLASHING!
BATTERIES MUST BE DISPOSED OF PROPERLY**

RADIO OPERATION

ANTENNAS

AM-This unit has a built-in ferrite rod antenna, which eliminates the need for an external antenna, and provides adequate reception in most areas. If reception is weak, turn the unit to improve receipt.

FM- The telescopic antenna on the top of the unit is for FM reception only. If reception is weak, adjust the length and the angle of the antenna.

LISTENING TO RADIO STATION

1. Set FUNCTION selector to (1) RADIO position.
2. Set BAND selector (6) to the AM or FM / FM ST. Position.
3. Tune a desired station by tuning the TUNING control (7).
4. Adjust VOLUME control (14) to suit your personal listening preference.
5. To switch the radio off, set the FUNCTION selector (1) to TAPE position.

CASSETTE TAPE OPERATION

TO PLAY CASSETTE

1. Set Function selector (1) to Tape position.
2. Lift up the cassette knob, then press STOP/EJECT button to open the cassette compartment.
3. Insert a recorder cassette tape in the cassette compartment with exposed side facing up.
4. Press PLAY button to begin playback.
5. To stop the tape, press STOP/EJECT button.
6. To advance or rewind the tape rapidly, press the Fast Forward ◀◀ or Rewind ▶▶ buttons. To resume normal playback press the Cassette Play ◀ button
7. To pause temporarily during playback, press the Cassette Pause || button. Press Pause again to cancel the pause mode and resume playback.

TO RECORD CASSETTE TAPE

Your equipment is able to record your desired sound source either from compact disc player or radio on a cassette tape.

1. Lift up the cassette knob cover, then press STOP/EJECT button to open the cassette compartment.
2. Insert blank cassette tape in the cassette compartment with exposed side facing up.
3. Depress PAUSE button.
4. Depress RECORD button.
5. Select your desired program by setting FUNCTION selector (1) and play the program.
6. To start recording, press PAUSE button again.
7. To stop recording, press STOP/EJECT button.

* The recording level is automatically adjusted by built-in ALC circuit.

* The recording level is not affected by VOLUME (14) control, so you can listen to the program with any volume.

CD OPERATION

CD DISPLAY

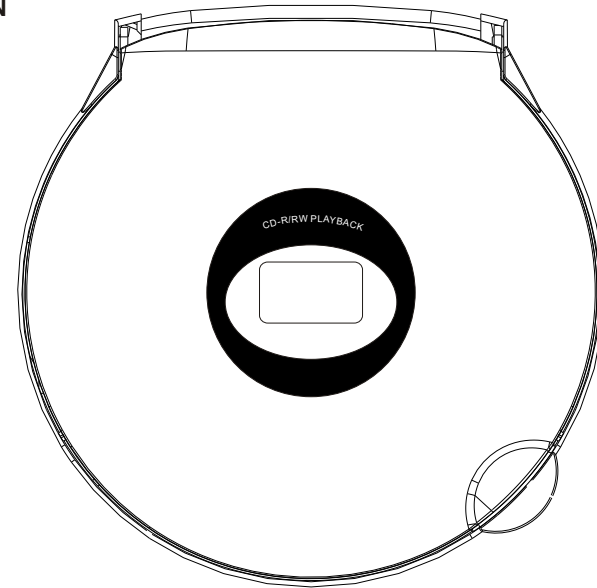

- | | |
|-------------------------|---|
| 1. Track Indicator | - Shows the total number of tracks or the currently player track. |
| 2. Play/Pause Indicator | - Lights when a disc is playing
- Flash when Pause to Play . |
| 3. Repeat Indicator | - Show Repeat all when Repeat to Play a Disc
- Flash when Repeat to Play a desire track. |
| 4. CD-RW Indicator | - Lights when a Rewritable disc is playing |

PLAYING A DISC

This unit is capable of playing standard CDs or 3 single discs: no adapter is required.

1. Set FUNCTION selector to CD position.
2. Pull the CD door to open the CD compartment.
3. Insert a CD disc to the CD compartment.
4. Close the CD compartment. The total number of tracks will be displayed and the CD player will stop. If a disc is inserted incorrectly, dirty, damaged or not present at all, the CD display will show - and the CD player will stop.
5. Press PLAY/PAUSE "▶||" button to begin playback.
6. Press STOP "■" button to stop.
7. Press : REPEAT button for repeat play.

PAUSE

This disc can be paused at any time during play by pressing the PLAY/PAUSE "▶||" button once. The PAUSE indicator will flash. Press the PLAY/PAUSE "▶||" button again to continue.

Skip/Search ◀◀ or ▶▶ Buttons

- Press the Skip/Search ▶▶ button once during playback to skip to the beginning of the next track. Continue to press this button to skip forward to higher numbered tracks until you reach the desired track.
- Press the Skip/Search ◀◀ button once during playback to skip to the beginning of the current track. Press twice to skip back to the beginning of the previous track. Continue to press this button to skip backward to lower numbered tracks until you reach the desired track.
- Hold the Skip/search ▶▶ or ◀◀ buttons during playback to rapidly search forward or backward through the disc to locate a specific passage within a track that you wish to bypass or to hear again.
- High speed search continues as long as the Skip/Search ▶▶ or ◀◀ buttons are depressed. Normal playback resumes when the Skip/Search ▶▶ or ◀◀ buttons are released.

NOTE: To begin playback of a disc on a specific track, wait until the player reads the disc and displays the total track number, then press the Skip/Search ▶▶ or ◀◀ buttons repeatedly until the desired track number is on the display. Press the ▶ button to begin playback on that track.

Repeat Playback

This function allows you to repeat either a single track or the entire disc continuously.

To repeat a single track - Select the track you wish to repeat and begin playback on that track. Then press the REPEAT button once. The REPEAT indicator appears in the display and the selected track will be repeated continuously until you cancel the repeat function or press the Stop ■ button.

To repeat the entire disc - Press the REPEAT button until the □ REPEAT □ and □ ALL □ indicators appear in the display, then press the ▶ button to begin playback if necessary. The entire disc will be repeated continuously.

To cancel Repeat Playback press the REPEAT button until the REPEAT indicator no longer appears in the display. Repeat can also be cancelled by pressing the Stop ■ button, opening the CD door, or switching the FUNCTION Selector to TAPE (OFF).

Dynamic Bass Boost System (DBBS)

This special circuit provides bass response, especially at low volume levels where the bass has a tendency to disappear. Set the DBBS button to On ■ to increase the bass. Set the DBBS button to Off ■ for normal bass response.

Note: If you have the DBBS circuit On at high volume and you are listening to music that contains very strong bass, you may experience some distortion. If this occurs, reduce the volume or switch the DBBS button Off .

STEREO HEADPHONE JACK

Connect the stereo headphones to the 3.5mm PHONES jack located at left top panel for private listening. When the headphones are connected, the sound from the speakers will automatically cut off. Before putting the headphones on your head, reduce the volume to a low level. Then put the headphones on and gradually increase the volume to a comfortable listening level.

Programmed Playback

The CD Player in this unit has a 32 track programmable memory which allows you to program up to 32 tracks on any disc for playback in any desired order. To program tracks for playback the player must be in the Stop mode. If the disc is playing, press the Stop ■ button to stop playback and then proceed as follows:

(1) Press the PROGRAM button once. The PROG. (Program) indicator begins flashing in the display and the 01 appears indicating that you should select the track that you wish to enter into program memory number 1.



(2) Use the ▶▶ or ◀◀ buttons to select the first track to be programmed. Example: Track 7. "07" indicator flashes in the display.



(3) Press the PROGRAM button again. This will store track 7 into program memory number 1. The display will now select the track to be entered into program memory #2.



(4) Repeat steps (2.) And (3.) Until you have programmed up to a maximum of 32 tracks into the programmable memory.

(5) To begin Programmed Playback press the ▶ button. The PROG Indicator stops flashing and remains On. The player will begin to play the tracks in the order that you selected.

CARE AND MAINTENANCE

SAFEGUARD AGAINST ACCIDENTAL ERASURE

When a new recording is made, any program material previously recorded is automatically erased and only the new recording remains. To safeguard valuable recordings from being erased accidentally, the cassette and the deck are equipped with a special device.

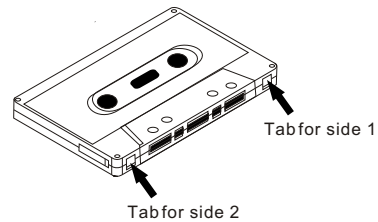

On the back of the cassette there is an erase prevention tab on each side. To prevent accidental erasing, break out these tabs with a screwdriver. If only one side of the tape is to be protected break out the tab on the left side with the side desired facing you.

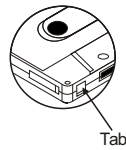

Tab

To record on a tape in which the tab has been broken, place a piece of adhesive tape over that area.

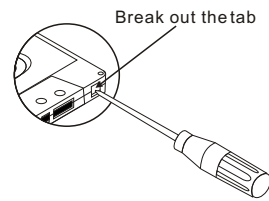

Break out the tab

NOTE: When a tab is broken out, the record button cannot be depressed.

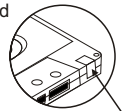

Cover with tape

CASSETTE TAPE RECOMMENDATIONS

Standard tape lengths have 15 (C-30), 30 (C-60) and 45 (C-90) minutes of recording time on each side. Longer length tapes of 60 (C-120) minutes of recording time on each side are not recommended. Use only high quality tapes. If a problem develops, check the unit first with another cassette to determine if the problem is with the cassette, and not with the unit.

If there is any stack in the tape in the cassette, it should be removed before inserting the cassette. Place a pencil in one of the hubs and rotate toward the outside of the cassette until all stack is taken up.

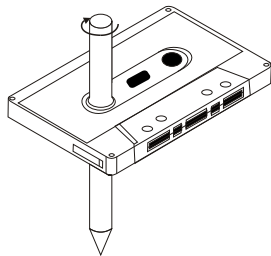

CARE AND MAINTENANCE

Caring for Compact Discs

- * Treat the disc carefully. Handle the disc only by its edges. Never allow your fingers to come in contact with the shiny, unprinted side of the disc.
- * Do not attach adhesive tape, stickers, etc. to the disc label.
- * Clean the disc periodically with a soft, lint-free, dry cloth. Never use detergents or abrasive cleaners to clean the disc. If necessary, use a CD cleaning kit.
- * If a disc skips or gets stuck on a section of the disc, it is probably dirty or damaged (scratched). When cleaning the disc, wipe in straight lines from the center of the center of the disc to the outer edge of the disc. Never wipe in circular motions.

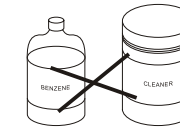
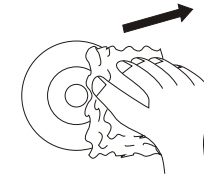
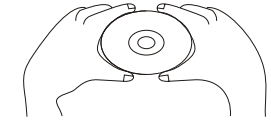

- * This unit is designed to play only compact discs bearing the identification logo as shown here.
- * Other discs may not conform to the CD standard and may not play properly.
- * Compact Disc should be stored in their cases after each use to avoid damage.
- * Do not expose compact disc to direct sunlight, high humidity, high temperatures, or dust, etc. Prolonged exposure or extreme temperatures can warp the disc.
- * Do not stick or write anything on either side of the disc. Sharp writing instruments, or think may damage the surface.



Cleaning the unit

- * To prevent fire or shock hazard, disconnect your unit from the AC power source when cleaning.
- * The finish on your unit may be cleaned with a dust cloth and cared for as other furniture. Use caution when cleaning and wiping the plastic parts.
- * Mild soap and a damp cloth may be used on the front panel.
- * Periodic cleaning of the tape heads, capstan and pinch roller is necessary to maintain good sound reproduction. Clean them after every 100 hours of use or less if playback has deteriorated. Use a cotton swab moistened with head cleaning solution or isopropyl alcohol, then wipe dry with another swab.

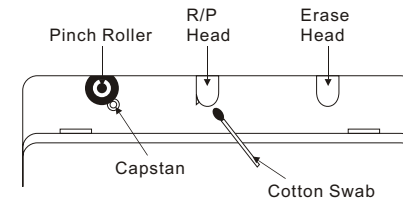

NOTE: Never use metal objects on or near the tape heads. Do not allow any cleaning material to fall into the tape assembly.

TROUBLESHOOTING GUIDE

Should this unit exhibit a problem, check the following before seeking service.

Symptom	Possible Cause	Solution
Radio		
Noise or sound distorted on radio broadcasts.	Station not tuned properly for AM or FM.	Retune the AM or FM broadcast station.
	FM: Telescopic antenna is not properly adjusted.	Reorient FM telescopic antenna.
	AM: Unit is not positioned correctly	Rotate unit until best reception is obtained.
FM STEREO indicator does not light.	Poor FM signal being received or BAND switch is not set to FM STEREO.	Retune station, try another station or set BAND switch to FM STEREO.
	Station is not broadcasting in stereo.	Change stations.
AM or FM, no sound.	FUNCTION switch is not set to the RADIO position.	Slide the FUNCTION switch to the RADIO position.
	Volume at minimum.	Increase Volume.
Cassette Player		
No sound.	FUNCTION switch is not set to the TAPE position.	Slide the FUNCTION switch to the TAPE position.
	Volume at minimum.	Increase Volume.
Sound distorted.	Dirty head.	Clean the head.
Speed varies.	Tape old or worn.	Replace the tape.
	Batteries are low.	Replace the batteries.
Cassette Recorder		
Will not record.	Erase prevention tab removed.	Cover hole with adhesive tape.
Distorted sound on playback.	Defective taps or dirty tape head.	Replace tape or clean tape head.
Compact Disc Player		
CD Player will not play.	FUNCTION switch is not set to the CD position.	Slide the FUNCTION switch to the CD position.
	CD is not installed or installed upside-down.	Insert CD with label side up.
CD skip while playing.	Disc is dirty or scratched.	Wipe disc with cloth or use another disc.
General		
No Sound.	Headphones connected into the Headphones jack.	Remove the Headphones from the Headphones jack.

Free Manuals Download Website

<http://myh66.com>

<http://usermanuals.us>

<http://www.somanuals.com>

<http://www.4manuals.cc>

<http://www.manual-lib.com>

<http://www.404manual.com>

<http://www.luxmanual.com>

<http://aubethermostatmanual.com>

Golf course search by state

<http://golfingnear.com>

Email search by domain

<http://emailbydomain.com>

Auto manuals search

<http://auto.somanuals.com>

TV manuals search

<http://tv.somanuals.com>