

USER'S GUIDE IQ-18W

CASIO®

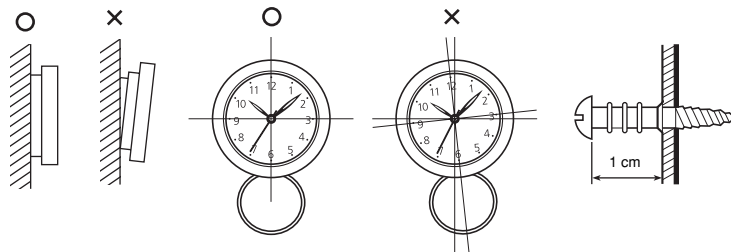
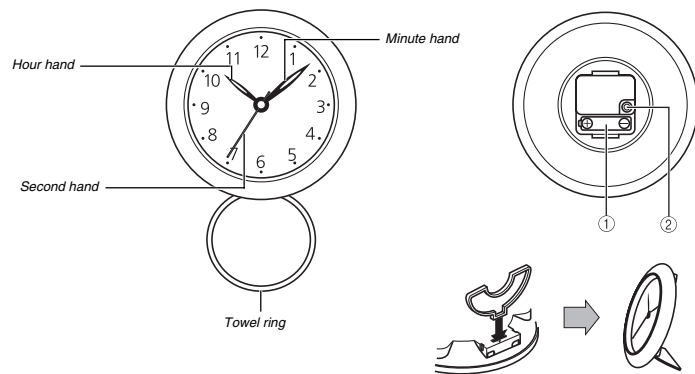

- A sticker is affixed to the display of this clock when you purchase it. Be sure to remove the sticker before using the clock.
- Depending on the clock model, the configuration of your clock may differ somewhat from that shown in the illustration.

TO START CLOCK

Insert a battery into **battery compartment** (①) with polarity as indicated.

TO SET TIME

Turn the **hour/minute adjuster** (②) in either direction.

TO ADJUST SECONDS

Remove the battery to stop the second hand at 12 o'clock position. Replace the battery at a time signal to restart the second hand on the correct second.

HANGING A TOWEL FROM THE CLOCK

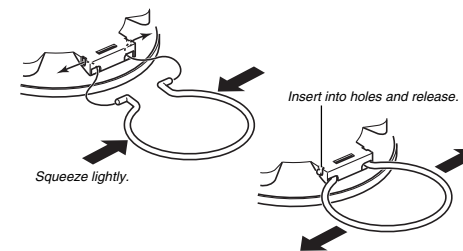

The clock comes with a detachable towel ring. Lightly squeeze the two sides of the towel ring together, insert the ends of the ring into the holes of the clock as shown in the illustration, and then release.

REPLACING THE BATTERY

Low battery power is indicated when timekeeping slows or stops completely. Should either of these symptoms occur, replace the battery immediately. Do not leave a low or dead battery in the clock.

To replace the battery

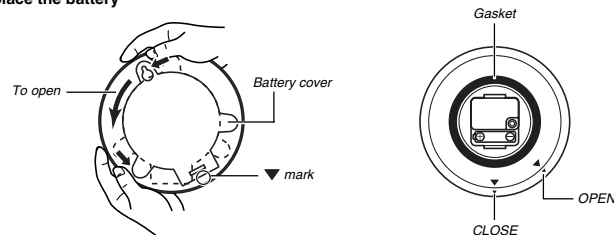

1. Remove the battery cover.
 - Rotate the battery cover so its ▼ mark moves from CLOSE to OPEN.
2. Remove the old battery.
3. Load a new battery, making sure that its positive (+) and negative (-) ends are facing correctly.
 - Loading a battery incorrectly can cause it to burst and damage the clock.
4. Replace the cover.
 - Place the battery cover onto the clock so its ▼ mark is initially aligned with OPEN. Next, rotate the cover so the ▼ mark moves from OPEN to CLOSE.
 - The battery cover can fall off or water can get into the clock if the cover's ▼ mark is not pointed at CLOSE.
 - Dirt or dust on the battery compartment gasket can allow water to get into the clock. Use a soft, dry cloth to wipe the gasket clean before replacing the battery cover.

Battery precautions

- Keep batteries out of the reach of small children. If a battery is accidentally swallowed, contact your physician immediately.
- Be sure to load the battery with its positive (+) and negative (-) ends facing correctly.
- Never charge the battery that comes with the clock.
- Should a battery ever leak while in the clock, wipe out the fluid with a cloth, taking care not to let any get onto your skin.
- Replace the battery at least once a year, even if the current battery is working normally.
- The battery that comes with the clock loses some power during transport and storage.

Free Manuals Download Website

<http://myh66.com>

<http://usermanuals.us>

<http://www.somanuals.com>

<http://www.4manuals.cc>

<http://www.manual-lib.com>

<http://www.404manual.com>

<http://www.luxmanual.com>

<http://aubethermostatmanual.com>

Golf course search by state

<http://golfingnear.com>

Email search by domain

<http://emailbydomain.com>

Auto manuals search

<http://auto.somanuals.com>

TV manuals search

<http://tv.somanuals.com>