

QuietCab Elite™ Cabinet Assembly Instructions

Make sure you have the following items:

- A. (1) base
- B. (4) caster plates
- C. (4) load-bearing casters with (16) M6 pozi pan screws
- D. (4) corner posts with (16) M6 pozi pan screws
- E. (4) mounting angles with (16) M6 pozi pan screws
- F. (72) M6 pozi pan screws
- G. (32) M6 socket button screws
- H. (1) 4-mm Allen key
- I. (1) top cover
- J. (4) depth-support rails with (16) M6 pozi pan screws
- K. (4) infills with (24) M6 pozi screws
- L. (8) 16-mm gasket foam side panels
- M. (8) 100-mm front and rear gasket foam panels
- N. (1) anti-recirculation kit ([5] pieces per side and [6] pieces for top and bottom front)
- O. (2) side panels
- P. (1) front left door
- Q. (1) front right door
- R. (1) rear left door
- S. (1) rear right door

Follow these instructions to assemble your QuietCab Elite Cabinet:

STEP 1. Install the (4) caster plates (Item B) onto the base (Item A).

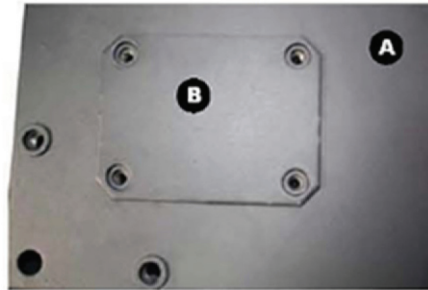

STEP 2. Secure the casters (Item C) to each plate (Item B) using (4) M6 pozi pan screws (Item F).

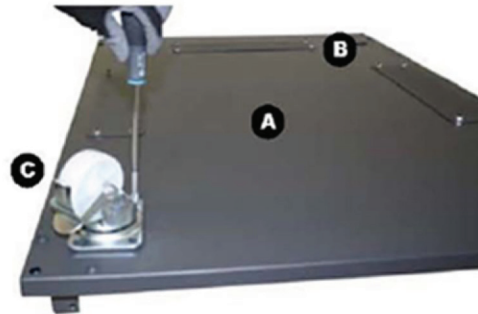

STEP 3. Position the corner posts (Item D) onto the base (Item A) and secure with M6 socket button screws (Item G) using the 4-mm Allen key (Item H).

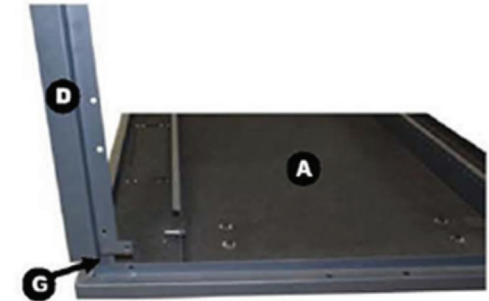

STEP 4. Install the top cover (Item I) onto the (4) corner posts (Item D). Secure in place with M6 socket screws (Item G) using the Allen key (Item H).

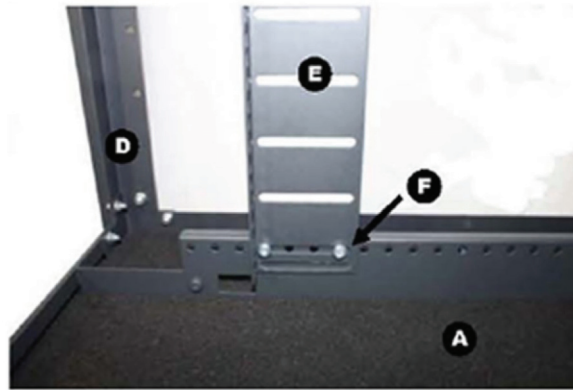

STEP 5. Position the (4) mounting angles (Item E) and secure them in place with M6 pozi pan screws (Item F).

NOTE: Make sure you use the deepest product to gauge the distance between front and rear mounting angles. Leave a distance of 1.9" (50 mm) between any mounted equipment and the front and rear doors.

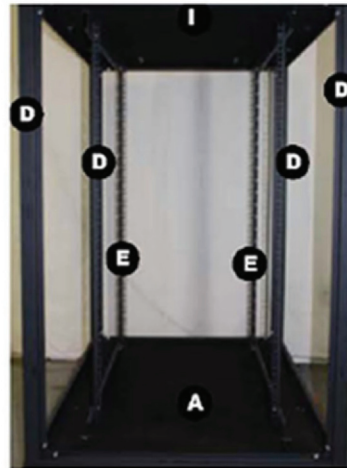
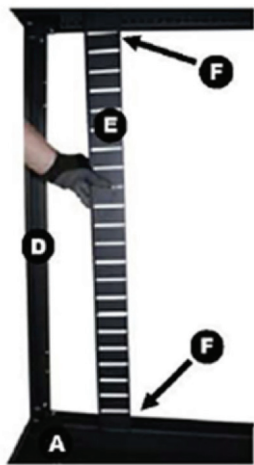

STEP 6. Install the (4) depth-support rails (Item J) to both cabinet sides (top and bottom) using (4) M6 socket button screws (Item G).

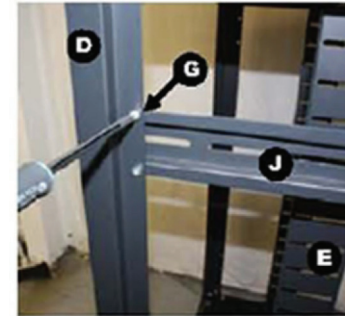

STEP 7. Install the (4) infill panels (Item K) parallel to the mounting angles. Attach the depth support rails using M6 pozi pan screws (Item F).

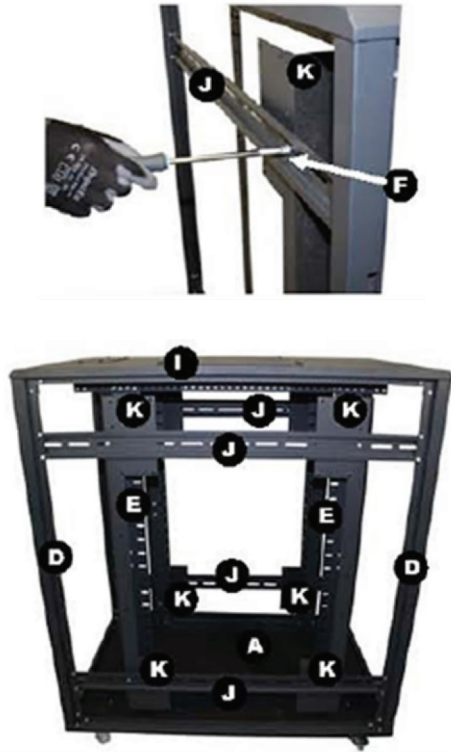

STEP 8. Install the gasket foam (Item L and Item M) to the complete sides, front, and rear of cabinet.

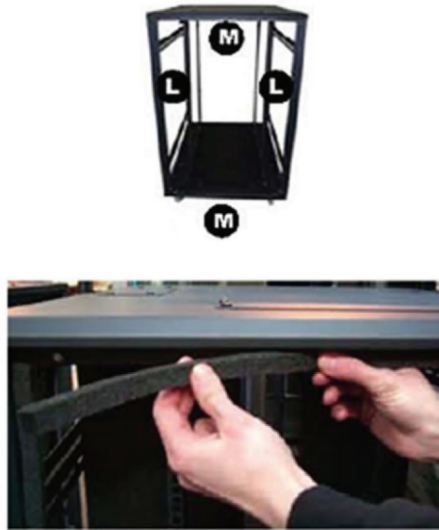

NOTE: Make sure that the gasket isn't stretched. Using your thumbs, install the gasket into place. Remember that the 0.6" (15-mm) gasket is for the sides and the 0.4" (10-mm) gasket is for the front and rear.

STEP 9. Install the anti-recirculation kit (Item N) into the side and front fascias. Make sure there are no gaps.



STEP 10. Install the side panels (Item O) into the location pins on the base. Fit the front and rear doors (Item R and Item S) onto the hinges.



Free Manuals Download Website

<http://myh66.com>

<http://usermanuals.us>

<http://www.somanuals.com>

<http://www.4manuals.cc>

<http://www.manual-lib.com>

<http://www.404manual.com>

<http://www.luxmanual.com>

<http://aubethermostatmanual.com>

Golf course search by state

<http://golfingnear.com>

Email search by domain

<http://emailbydomain.com>

Auto manuals search

<http://auto.somanuals.com>

TV manuals search

<http://tv.somanuals.com>