

3.5mm Portable Mini Speaker Quick Start Guide

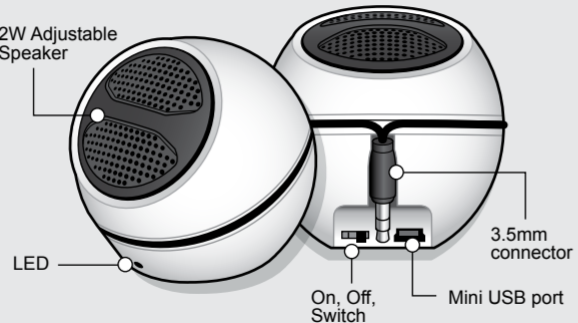

APS01F

Product Highlights



Operation

Listening to Music (Wired connection)

1. Unwind the connector cable from around the speaker.
2. Connect any digital device with a 3.5mm audio jack port like an iPod, iPad, iPhone, smartphones and tablets.
3. Turn the speaker to ON. The blue LED will illuminate.
4. Press play from your connected device and enjoy!

Download from [Www.Somanuals.com](http://www.Somanuals.com). All Manuals Search And Download.

Charging the battery

1. Connect the provided USB charging cable to the mini USB port on the speaker.
2. Connect to a USB port on your computer or laptop
3. While charging, the power indicator LED will turn red.
4. When fully charged, the power indicator will turn off.

Tech Support & Warranty Information

If you need further assistance, please contact the Aluratek support department for troubleshooting prior to returning this device.

E-mail: support@aluratek.com

Web: www.aluratek.com/support

Local (Tustin, CA): 714-586-8730

Toll free: 1-866-580-1978

Aluratek warrants this product against defect in material or workmanship for **1 Year** from the date of purchase.

For more information, please visit: <http://aluratek.com/warranty-return-policy>
You can register your product online at: <http://aluratek.com/product-registration>

Radio and TV Interference Statement

WARNING!!! This equipment has been tested and found to comply with the limits of a Class B digital device, pursuant to part 15 of the FCC rules. These limits are designed to provide reasonable protection against harmful interference in a residential installation.

This equipment generates, uses and can radiate radio frequency energy and, if not installed and used in accordance with the instruction, may cause harmful interference to radio communications. However, there is no guarantee that interference will not occur in a particular installation. If this equipment does cause harmful interference to radio or television reception, which can be determined by turning the equipment off and on, the user is encouraged to try to correct the interference by whatever measures may be required to correct the interference.

Free Manuals Download Website

<http://myh66.com>

<http://usermanuals.us>

<http://www.somanuals.com>

<http://www.4manuals.cc>

<http://www.manual-lib.com>

<http://www.404manual.com>

<http://www.luxmanual.com>

<http://aubethermostatmanual.com>

Golf course search by state

<http://golfingnear.com>

Email search by domain

<http://emailbydomain.com>

Auto manuals search

<http://auto.somanuals.com>

TV manuals search

<http://tv.somanuals.com>