



All products are trademarks of Nostalgia Products Group, LLC.  
Worldwide design & utility patented or patents pending.  
© 2010 Nostalgia Products Group, LLC.

[www.nostalgiaelectrics.com](http://www.nostalgiaelectrics.com)

(rev. 07/13/10)



**FG100 SERIES**

## **Folding Griddle**

Instructions and Recipes



# CONTENTS

SAFETY . . . . .	2
IMPORTANT PRECAUTIONS . . . . .	3
IMPORTANT SAFEGUARDS . . . . .	3
INTRODUCTION . . . . .	4
PARTS & ASSEMBLY . . . . .	5
HOW TO OPERATE . . . . .	5
HELPFUL TIPS . . . . .	6
CLEANING & MAINTENANCE . . . . .	7
RECIPES . . . . .	7
RETURNS & WARRANTY . . . . .	8

## SAFETY

Your safety and the safety of others are very important.

We have provided many important safety messages in this manual and on your appliance. Always read and obey all safety messages.

This is the safety alert symbol.



This symbol alerts you to potential hazards that can kill or hurt you and others.

All safety messages will follow the safety alert symbol.

All safety messages will tell you what the potential hazard is, tell you how to reduce the chance of injury, and tell you what can happen if the instructions are not followed.

### Appliance Specifications:

120 Volts, 60 Hz, 1200 Watts, ETL Approved

## IMPORTANT PRECAUTIONS

1. NEVER immerse appliance or cord in water.
2. NEVER use near water.
3. NEVER use an abrasive sponge or cloth on the appliance.
4. NEVER leave appliance unattended while in use.
5. NEVER place anything other than what is intended to be cooked on the Griddle.
6. Always use FOLDING GRIDDLE with Drip Tray in place.
7. Unplug appliance from outlet when not in use and when cleaning.
8. DO NOT place appliance in dishwasher.
9. Keep out of reach of children.
10. This appliance is NOT A TOY.
11. This appliance is not intended for use by young children or the cognitively challenged without supervision.
12. Young children should be supervised to ensure that they do not play with the appliance.
13. DO NOT use outdoors.

## IMPORTANT SAFEGUARDS

When using electrical appliances, basic safety precautions should always be followed, including:

1. **Read all instructions before operating this appliance.**
2. DO NOT touch hot surfaces.
3. DO NOT use outdoors. FOR HOUSEHOLD USE ONLY.
4. To protect against risk of electrical shock, do not immerse cord, plugs or appliance in water or any other liquid.
5. DO NOT operate any appliance with a damaged cord or plug, after the appliance malfunctions, or if it is dropped or damaged in any manner. Return the appliance to the nearest authorized service facility for examination, or to a repair shop for electrical or mechanical adjustment.
6. The appliance manufacturer does not recommend the use of accessory attachments other than what is supplied with the unit. They may cause injuries.
7. When any appliance is used by or near children, adult supervision is strongly recommended.
8. DO NOT place on or near a hot gas or electric burner, or in a heated oven.
9. DO NOT overload wall outlet or extension cords as this can result in a risk of fire or electric shock.
10. This appliance should not be used for purposes other than stated in the instructions accompanying this appliance.
11. DO NOT leave unit unattended while in use or when plugged into an outlet.

12. Unplug from outlet when not in use and before removing parts for cleaning. Allow to cool before putting on or taking off parts and before cleaning the appliance.
13. To reduce the risk resulting from becoming entangled or tripping over a long cord, a short power supply cord is provided.
14. Extreme caution should be used when moving an appliance with hot food.
15. It is NOT recommended to use an extension cord with this appliance.
16. Do not attempt to service this appliance yourself, as opening or removing covers may expose you to dangerous voltage or other hazards. Refer all servicing to qualified service personnel.
17. Be sure to unlock the unit before opening and lock after closing.
18. NEVER close unit while griddle is still hot.
19. If griddle is on when closed, unit will automatically turn off.
20. DO NOT let cord hang over the edge of countertop or touch hot surfaces.
21. Check the Drip Tray frequently during cooking sessions to prevent overflow.
22. **SAVE THESE INSTRUCTIONS!**

## INTRODUCTION

Thank you for purchasing the FOLDING GRIDDLE from Nostalgia Electrics™. The griddle is made of die cast aluminum for even heat dispersment and has a non-stick surface. It has a grease trough in the middle so that grease and cuts of fat slide off the griddle into the drip tray. The lightweight and slim design makes this unit great for use at home, in the RV during camping trips and to bring to the office. Best of all, the unit folds for easy storage. The variety of meals that can be created using the FOLDING GRIDDLE are endless, making this a must-have item for every modern household.

The FOLDING GRIDDLE is your perfect prep assistant for breakfast, lunch and dinner! Features include:

- Helps Create Quick, Easy-to-Cook Meals
- Two 10" x 10" Cooking Surfaces, with Total Cooking Space of 200 sq. in.
- Two Power Lights
- Dual Thermostats Allow You to Cook Separate Dishes on Each Side of the Griddle at the Same Time or Use One Side as a Warmer
- Nonstick Coating
- Non-Clogging Pull-Out Tray Holds Drippings of up to 1 lb. Bacon Grease
- Built-in Handle for Portability
- Lock at Top of Unit Keeps it Securely Folded
- Slim, Folding Design for Simple Storage
- Lightweight
- Easy to Use, Easy to Clean

## PARTS & ASSEMBLY

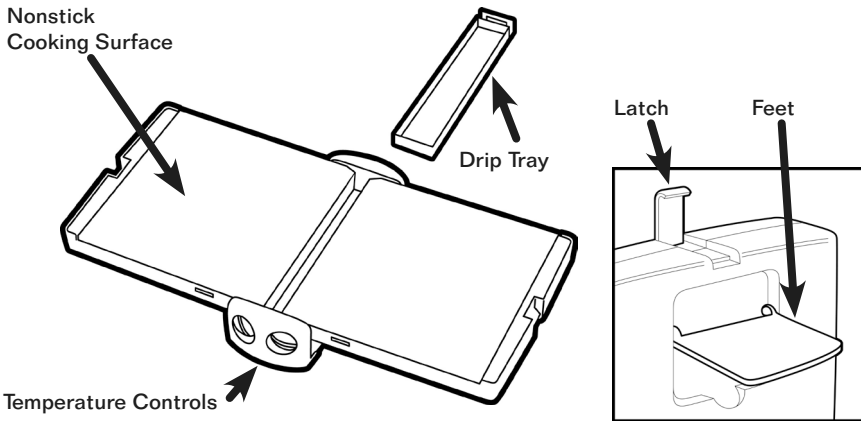

### SWITCH POSITIONS

Left Dial: Low to High / Right Dial: Low to High



## HOW TO OPERATE

1. Before first use, wipe down all surfaces with a non-abrasive, damp cloth and dry.
2. Find a clean, dry, non-slippery, level surface near an electrical outlet.
3. Allow about eight inches of clear space all around the exterior of the unit.
4. Unlock the Latch on Handle before opening.
5. Extend Feet on both sides of the Griddle so that Griddle is level.
6. Slide the Drip Tray into base of the Griddle.
7. The Nonstick Cooking Surface should be lightly coated with a small amount of vegetable oil. This can be applied with a paper towel. The oil will help protect the griddle. This should be done periodically to maintain the non-stick quality.
8. Plug the cord into the wall outlet and turn thermostat on each side of the Griddle to desired temperature setting.
9. Preheat the appliance for a minimum of 3-5 minutes.
10. During this time, you may notice slight smoking or a slight odor; this is normal with most new appliances. The smoking and odor is caused

by the residues burning off the Nonstick Cooking Surface. Allow the appliance to preheat until smoke and odor no longer exists.

11. While the appliance is preheating, you may prepare the ingredients for the food to be cooked.
12. NEVER leave the appliance unattended.
13. The cooking time depends on the dish that is being made.
14. Remove foods from the griddle with a flat plastic or wooden utensil. DO NOT use metal utensils, as they may scratch and damage the Nonstick Cooking Surface.
15. Make sure that you turn the temperature all the way down on both griddles before unplugging the appliance to prevent any sparking from the outlet.
16. Once the appliance is cool, remove the Drip Tray to empty and clean.
17. Some meats can create a lot of fat drippings. When cooking meat, be sure to check the Drip Tray periodically to prevent overflow.
18. Wear oven mitts while using the FOLDING GRIDDLE to prevent burns.

## HELPFUL TIPS



**NEVER leave the appliance unattended while operating.**

The cord folds into the Drip Tray for easy storage. See steps below.

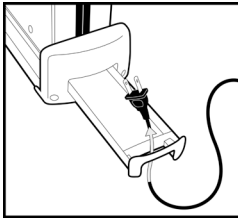

**Thread** cord through Drip Tray handle.

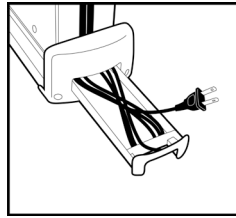

**Fold** cord into Drip Tray.



**Pull plug down and through** Drip Tray handle. Push Drip Tray back into griddle base.



## CLEANING & MAINTENANCE

Please take care of your FOLDING GRIDDLE by following these simple instructions. Cleaning is a snap.

- Make sure temperature is turned all the way down, then unplug appliance cord from the outlet.
- Make sure the appliance is cool before removing the Drip Tray.
- Empty the Drip Tray.
- Clean Drip Tray in warm, soapy water. Rinse and dry.
- Wipe the Nonstick Cooking Surface and base with a damp, non-abrasive cloth and dry.
- To prolong the life of the coating on the Nonstick Cooking Surface, never stack objects other than food on the surface and never use a metal spatula or metal tongs to turn or flip foods.
- Never put the appliance in a dishwasher.

It is that simple. Remember to lightly coat the Nonstick Cooking Surface with vegetable oil prior to cooking to preserve the nonstick finish.

## RECIPES

Use your imagination and choose favorite ingredients to create a variety of meals using the FOLDING GRIDDLE.

Cook a batch of pancakes on one griddle and keep them warm on the other prior to serving.

The variety of meals and foods that can be cooked on the FOLDING GRIDDLE is virtually endless. Make grilled cheese, eggs, hash browns, pork chops, chicken, steak, fry bacon and more!

Be creative and ENJOY your FOLDING GRIDDLE!

# RETURNS & WARRANTY

SHOULD YOUR UNIT NOT WORK OR IS DAMAGED WHEN YOU FIRST TAKE IT OUT OF THE BOX, PLEASE RETURN IT TO THE PLACE OF PURCHASE IMMEDIATELY.

## FOLDING GRIDDLE / FG100 SERIES

Should you have any questions, please contact us via email or at the customer service number listed below between the hours of 8:00 AM and 5:00 PM, Monday through Friday, Central Standard Time.

### **Distributed by:**

Nostalgia Products Group LLC  
1471 Partnership Dr.  
Green Bay, WI 54304-5685  
Customer Service  
Phone: (920) 347-9122  
Web: [www.nostalgiaelectrics.com](http://www.nostalgiaelectrics.com)

### **Customer Service Inquiry**

To submit a Customer Service inquiry, go to [www.nostalgiaelectrics.com](http://www.nostalgiaelectrics.com) and fill out the Customer Service Inquiry form and click the Submit button.

A representative will contact you as soon as possible.

This appliance is designed and built to provide many years of satisfactory performance under normal household use. The distributor pledges to the original owner that should there be any defects in material or workmanship during the first 90 days of purchase, we will repair or replace the unit at our option. Our pledge does not apply to damages caused by shipping, mishandling or unit being dropped. A product deemed defective either from manufacturing or being mishandled is up to the distributor's discretion. In order to obtain service under this warranty, please contact Nostalgia Products Group, LLC at the telephone number listed above or by filling out the Customer Service Inquiry Form located at [www.nostalgiaelectrics.com](http://www.nostalgiaelectrics.com). This warranty does not apply to re-manufactured merchandise.

Please read these instructions carefully. Failure to comply with these instructions, damages caused by improper replacement parts, abuse or misuse will void this pledge to you and is being made in place of all other expressed warranties.





## Free Manuals Download Website

<http://myh66.com>

<http://usermanuals.us>

<http://www.somanuals.com>

<http://www.4manuals.cc>

<http://www.manual-lib.com>

<http://www.404manual.com>

<http://www.luxmanual.com>

<http://aubethermostatmanual.com>

Golf course search by state

<http://golfingnear.com>

Email search by domain

<http://emailbydomain.com>

Auto manuals search

<http://auto.somanuals.com>

TV manuals search

<http://tv.somanuals.com>